



# ENERSHIELD Air Barriers

Specializing in Energy Management Climate Control Systems

## Energy Saving Technology

Manufacturing & Design

16813 – 113 Avenue, Edmonton Alberta T5M 2X2

Phone (780) 482-4662 • Fax (780) 482-4074

Toll Free – 1-866-464-3667

www.enershield.ca

## Ultrashield US-240 - Air Barrier Specifications

Enershield model US-144 Enershield Air Barrier 240” (6096 mm) in length. Powder coated 1/8” steel frame construction & 20 gauge G.90 sheet metal jacket, c/w acoustic insulation. Provided with telescopic sliders & wall brackets. Remote NEMA 1 control panel incorporating soft start and photo electric cell door sensor for automatic activation upon door opening. Operating characteristics: 10 blowers providing Air Velocity = 6500 fpm, Air Volume = 39,750 cfm, Electrical: see chart below Motors: 2 @ 10 hp = 20 hp total (14,920 Watts). Weight = 1400 lbs. Decibel rating is 78 dB at a distance of 10’ from the unit. CSA Certified.

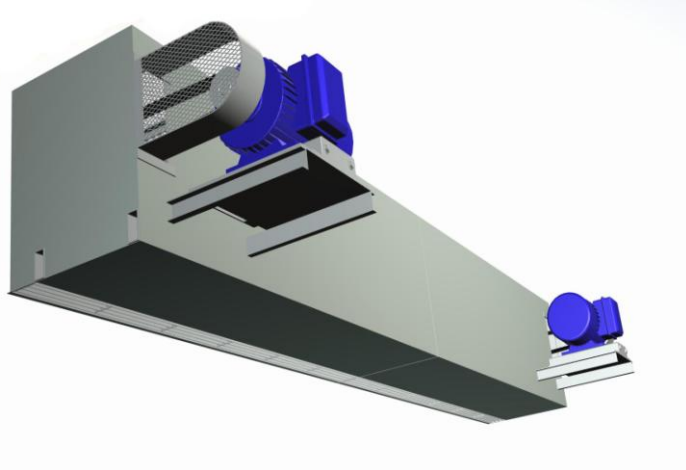

Model	US-240
<b>Cabinet Length in./mm</b>	240” 6096 mm
<b>Height x Width</b>	22”x 19 1/2” 559mm x 496mm
<b>Weight lbs/Kgs</b>	1400 lbs. 636 kgs.
<b>Horse Power</b>	10 hp 7,460 watts
<b>Fans/Blowers</b>	10
<b>Motors TEFC</b>	2
<b>Total Horsepower</b>	20 hp 14,920 watts
<b>Decibels</b>	78 dB
<b>Max FPM at Nozzle</b>	6500 fpm 33 m/s
<b>CFM at Nozzle</b>	39,750 cfm 18,760 l/s
<b>Outlet Velocity Uniformity</b>	95%

Available Motors			
Operating Voltage:	575/3/60	460/3/60	208/3/60 230/3/60
Amp Draw FLA	10.0 Amps	12.5 Amps	26.5Amps ea. 24.0 Amps ea.
<b>TEFC Motor 1750 RPM, IP55, VFD Compatible, T-Frame, 89.5% Eff.</b>			

nb: All units can be manufactured for a vertical application. Information available on request  
12/23/2010